

September Meeting

When: 7:00 pm
Monday, September 12, 2016

Where: Griffin School
5001 Evans Avenue

Note: HPNA meetings usually take place on the first Monday of each month.

HPNA General Meeting Agenda for September 12

- 🍷 Ice Cream Social
- Flooding in Hyde Park: Presentation and Discussion
- Traffic and Safety on 45th Street: Presentation and Discussion
- Standardized Communication to City about non DRC-Reviewed Projects - Vote
- Nominations for HPNA Officers and Steering Committee Members
- Announcements

See You There!

Calling Hyde Park Volunteers!

Summer is almost over, and with the cooler weather comes the start of another exciting season of HPNA-sponsored events. On Sunday, October 16, we will celebrate our local Engine 9 and the Fire Department with the Fire Station Festival, which includes a costume parade and numerous activities for the young and young at heart. Four short weeks later, on November 14, the 40th Annual Hyde Park Homes Tour will showcase a selection of fabulous and funky homes in our neighborhood. In December, friends and neighbors will come together to celebrate the season at the Hyde Park Holiday Party.

Each of these events, and those that follow next spring and summer, is made possible through the help of neighbors who donate their time and talent. To promote volunteerism, this year we are introducing an online system to make it easier for you to sign up to

Continued on page 13

*The Hyde Park
Neighborhood
Association*

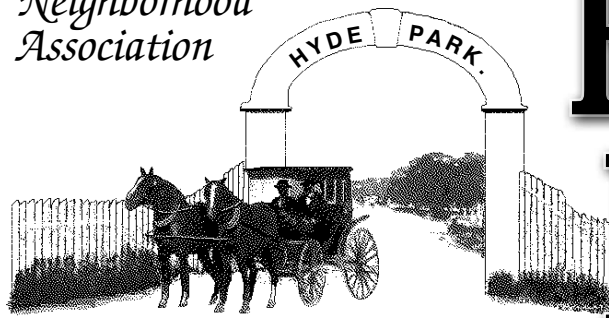

Pecan Press

September 2016 • National Register District Neighborhood • Vol. 42, No. 9

Flooding: It's Not Just Hyde Park's Problem

A Flood Mitigation Forum convened on August 10 at the Northwest Recreation Center, sponsored by City Council Member Leslie Pool (District 7).

The forum was well attended by about 90 residents, many from neighborhoods near Hyde Park. Its purpose was to report the results of a nine-month investigation by the Flood Mitigation Task Force (FMTF), whose volunteer members represented all ten City Council districts. Their work was completed in May and the results were reported to the City Environmental Commission. Several Task Force members presented a summary of their findings, and city staff from the Watershed Protection Department answered audience questions. Tellingly, Task Force members stated that they had not yet been invited to speak to the city's Planning Department or CodeNext. (Access the final task force report at www.austintexas.gov/fmtf).

The key takeaway from this meeting was that flooding issues are widespread in the older Central Austin neighborhoods. Overflowing creeks are only part of the problem; as we know, there is also serious street flooding due to antiquated storm drains that are inadequate to capture water runoff from heavy rains. This is compounded by a stagnant budget for drainage utilities despite Austin's growth in size, population, and density. Upstream development has increased the amount of impervious cover and created serious flooding issues downstream. Drainage bonds have not been funded since 2006. They estimate the costs to replace old substandard drainage pipes at \$162 million. City staff reported a backlog of several years for work orders for drainage pipe repair and replacement. There are only two city crews for water channel maintenance and inspection.

Many recommendations of the FMTF seek to correct the City's underfunding of flood mitigation, such as adoption of a city-wide flood mitigation prioritization policy based on safety and property damage risks; immediate preparation of drainage bonds to fund system improvements; more funding for regular creek maintenance and emergency flood events; and increased funding for large capital projects to mitigate flooding, of which the Watershed Protection Department has identified an "expensive and expansive list."

In lieu of increased funding for mitigation, one City response to recent flooding has been to redraw and expand the 100-year flood plain.

Continued on page 16



While the hot weather will be with us for a couple of more months, the summer is coming to a close. Hyde Park will once again welcome an influx of college students, and the familiar fall rituals of the neighborhood will start anew.

But we also have some new business coming up. For example, the HPNA nominating committee will be presenting a new slate of Steering Committee members for the membership to consider. We will also be discussing the future of Shipe Pool. Elsewhere in this issue (page 3), Susan Marshall describes the plans of the Austin Parks and Recreation department to renovate Shipe Pool. We urge you to read her article and decide whether you like the proposed redesign. Both of us are eager to hear your thoughts and opinions. Our email addresses can be found in the Hyde Park Neighborhood Association box on page 2.

Also in this issue (page 1), Susan Marshall has written an article about how the City is addressing flood mitigation. We as a neighborhood need to proactively work with city leaders to protect our streets and our homes from future damaging floods. After the flooding just a

For Vote: Standard Response to Austin Boards & Commissions

Blanket statement to be sent in response to City notifications about a property when the applicant has not yet met with the HPNA DRC:

"The Hyde Park Neighborhood Association cannot take a position on this application as the applicant has not met with the Neighborhood Association or our Development Review Committee and thus we do not have enough information to reach an informed decision."

few weeks ago, this situation continues to remain one of the biggest issues facing our neighborhood. Unfortunately, this problem is systemic and affects much of the City, and we need your support and voices to get the City to implement a solution that will prevent our neighbors from getting soaked.

New homes and development in Hyde Park often create controversy in HPNA. The HPNA has a standing Development Review Committee (DRC) that is designed to educate and work with builders and home owners on designs that match requirements of the neighborhood plan and local historic district. Additionally, the DRC's views are important to the City's Planning Commission. Unfortunately, not all neighbors or builders come before the DRC to discuss their plans and we are asked to comment on these plans. Therefore, we will be discussing ways to encourage neighbors to take advantage of this resource at our September meeting. To this end,



we will ask the membership to approve a blanket statement that we can send back to City Boards and Commissions indicating that we cannot comment on a project which has not meet with the DRC. This response is simply to encourage neighbors to avail themselves of this useful resource.

Several major neighborhood events are coming soon, including

Continued on page 7

Hyde Park Neighborhood Association

P. O. Box 49427 • Austin, TX 78765
www.austinhypark.org

– HPNA Officers & Steering Committee –

Co-Presidents

• Kevin Heyburn kmheyburn@gmail.com
• Reid Long reid.long@gmail.com

Co-Vice Presidents

• Kathy Lawrence mail@kathylawrence.com
• Adrian Skinner adrian.h.skinner@gmail.com

Co-Secretaries • Artie Gold • Susan Marshall

Co-Treasurers • PO Box 49427, Austin, TX 78765

• Mark Fishman mlfishman@gmail.com
• Susanna Walker suzwalkercpa@gmail.com

Additional Steering Committee Members:

• Sharon Brown • Joan Burnham • Jessica Charbeneau • Betsy Clubine • Dorothy Richter • John Williams • Lorre Weidlich • Karin Wilkins •

– HPNA Committees & Task Forces –

AISSD • Anne Hebert, anne@annehebert.com

Alley Coordinator • Carol Burton, sky2wash@austin.rr.com

ASH (joint HPNA-CT committee) • John Williams, jawilli@grandecom.net

Austin Neighborhoods Council Rep. •

Beautification • Robin Burch, robinburch@gmail.com
(903) 780-5275

Church-Neighborhood Liaison • Kathy Lawrence, mail@kathylawrence.com

CodeNEXT (joint HPNA-CT committee) • (unfilled)

Crime & Safety • Carol Welder, cjwelder@msn.com
• Kristen Remeza, kremeza@yahoo.com

Development Review • David Conner, daypaycon@yahoo.com

Finance • David Conner, daypaycon@yahoo.com

Graffiti Patrol • Lisa Harris, ljharris@yahoo.com
420-0652

Homes Tour • Carolyn Grimes, cgrimes@cbunited.com

Membership • Sharon Brown, donsharon4213@sbcglobal.net
• Karen Saadeh, kdmatthis@gmail.com

Neighborhood Planning • Karen McGraw, mcgrawka@earthlink.net

Neighborhood Outreach & Communications • Sharon Brown, donsharon4213@sbcglobal.net

Parks & Public Space • Mark Fishman, mlfishman@gmail.com

Social • Sarah Cook, cooksicle@gmail.com

Social Media Coordinator • Ellie Hanlon, ellie.hanlon@gmail.com

Tree Preservation • John Walewski, jwalewski@civil.tamu.edu

Website • Michael Crider, online@austinhypark.org

Zoning • Dorothy Richter, 3901 Ave. G 452-5117

Pecan Press

The *Pecan Press* is published monthly by the Hyde Park Neighborhood Association in Austin, Texas.

Advertising deadline: 15th of the month preceding publication.

Editorial deadline: 10th of the month preceding publication.

Editor

Lorre Weidlich pecanpress@austinhypark.org

Poetry Editor

Charlotte Herzele herzele@gmail.com

Photo Editor

Lizzie Chen

Puzzle Editor

Steve Bratteng

Kid's Corner

Jessica Charbeneau ppkidscorner@yahoo.com

Production Manager & Advertising Director

Robert M. Farr, 731-0617, bobfarr@austin.rr.com

Payments for Ads

HPNA, P.O. Box 49427, Austin, TX 78765

Distribution Coordinator

Rimas Remeza, 4105 Ave. F, 371-3158, rimasx@yahoo.com

Area Coordinators

N of 45th/W of Duval

• Rosa Maria Lopez Reed elsalvadorchrist@yahoo.com

N of 45th/E of Duval

• Jay Gerard & Carrie Laughlin 371-1546

S of 45th/W of Speedway

• Joanna Fitzgerald joannafitzgerald@icloud.com

S of 45th/E of Speedway

• Martha Campbell 452-2815

Shipe Pool Update: Meet the Medley

In 2014 a City of Austin study determined that the Shipe Park pool, built in 1934, would fail within five seasons. As a result, the City Council awarded the Parks and Recreation Department (PAR) an allocation of \$3,100,000 to refurbish the pool. Beginning in March of this year, four public meetings gathered community input on a new pool design. Three surveys have also solicited residents' opinions; according to the City's website, over 300 comments and over 400 participants from nine neighborhoods have weighed in. The design team began with three designs, each of which received some criticism; at a subsequent meeting, they offered two more designs that received pointed feedback. As a result of this collaborative process, the design team presented a new design at the July open house: the Medley.

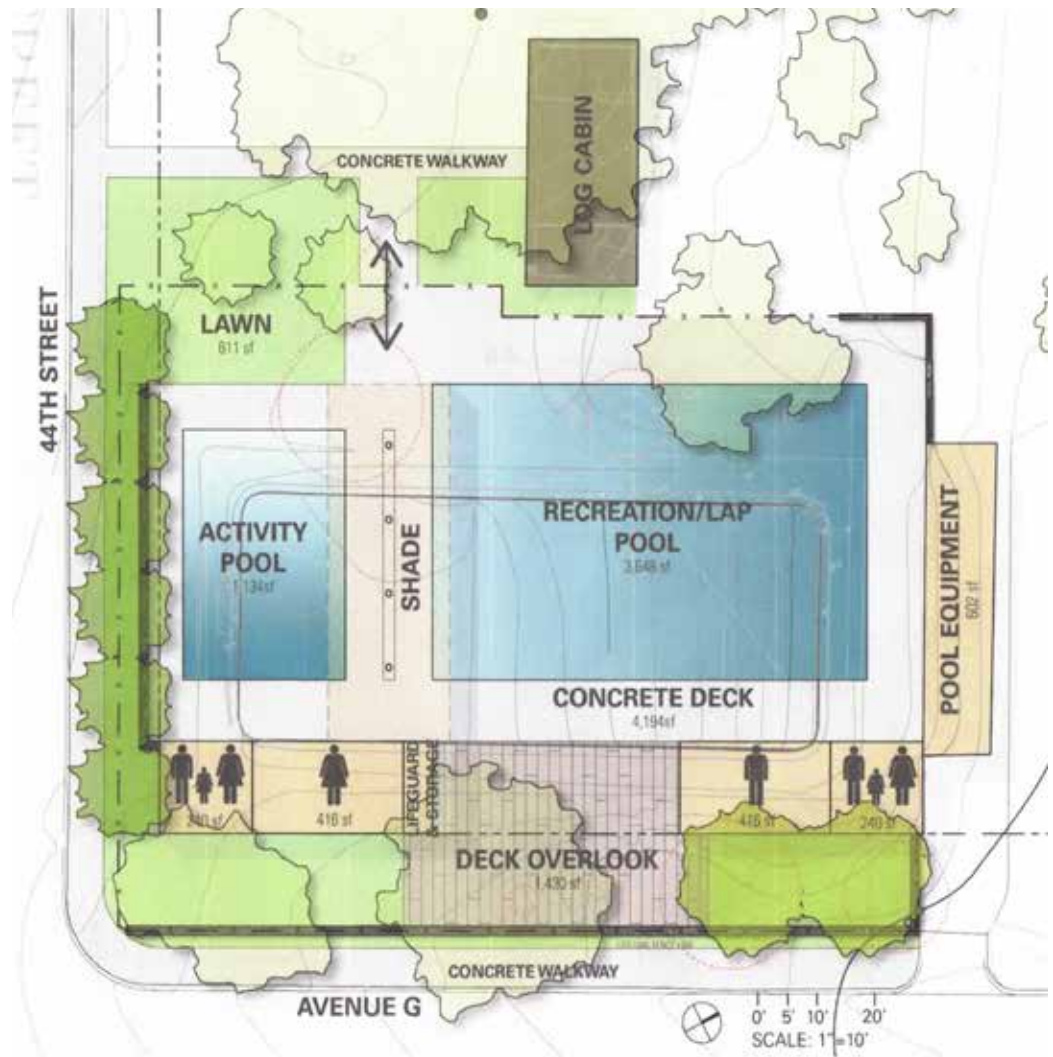

Continued on page 5

Membership Information

- Membership in HPNA is open to all residents 18 years or older residing within the boundaries of Hyde Park or within 300 feet of its boundaries.
- All memberships expire on September 30th of each year.
- New members and members who lapse in dues for over six months are eligible to vote at HPNA meetings 30 days after receipt of dues.
- Membership dues can be paid in several ways: By signing up at an HPNA meeting or event, by mailing in the membership form, or by joining online using PayPal. To pay online, go to www.austinyhydepark.org and click on the Join Now button. Dues paid online are \$6.

Submission Information

- Send your articles, letters, and photos by the 10th of each month to Lorre Weidlich at lweidlich@grandecom.net.
Opinion articles & letters to the editor must not exceed 500 words.
- Send your poems to Charlotte Herzele at herzele@gmail.com.
All poems, even if written under a pen name, must include a name and contact information for identification and verification purposes.
- Send your contributions to Kid's Corner to Jessica Charbeneau at ppkidscorner@yahoo.com.

Hyde Park Neighborhood Association Membership Form

Name _____ Phone _____

Address _____

Notify me by email of HPNA meetings & events _____

Dues Standard - \$5/yr. Check
 Senior - \$1/yr. Cash
 New Member Date _____
 Renewing Member Amount _____

Mailing Address:
 HPNA Membership
 P.O. Box 49427
 Austin, Texas 78765
 Make checks payable to HPNA.



THE HYDE PARK SPECIALIST

and Resident

SAM ARCHER

Until the 1880's, the Texas State Fair took place in Hyde Park. More than a century later, that same historic section of the city is once again attracting crowds as one of the most in-demand neighborhoods in all of Austin. I have lived in Hyde Park for 20 years and witnessed the area transform into a beautiful community that has seen a sweeping boost in property values and quality of life over the past decade. Whether you're looking to buy or sell a house here, my expertise and experience regarding the rich history of the homes in this classic Austin neighborhood will help ease the stress of the realty process. Contact me if you have questions or need any help planning your move.

Certified Negotiation Expert®

HELPING CLIENTS BUY & SELL IN AUSTIN WITH INTEGRITY & UNPARALLELED REPRESENTATION

HYDE PARK SOLD PRICE PER SF

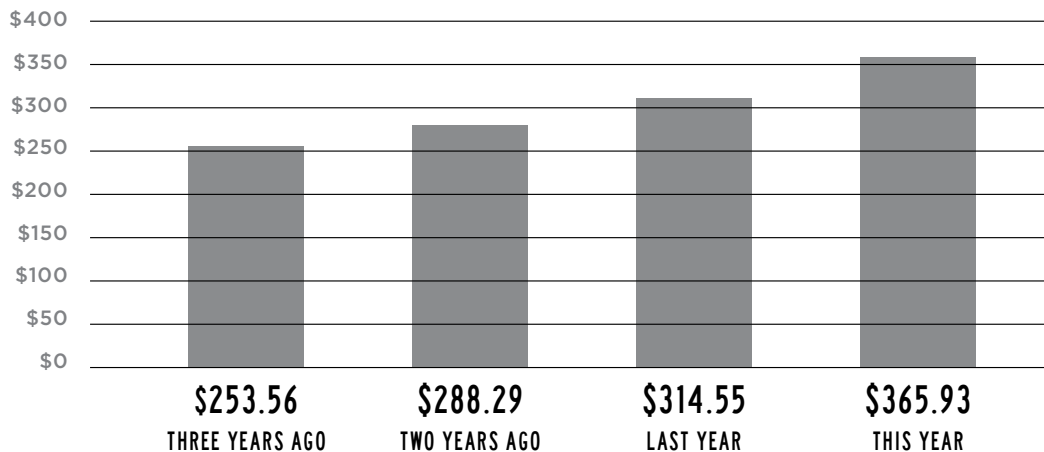

**YTD Numbers from the MLS for Single Family Residences taken 09/01/2015
For detailed market information about your home, contact Sam Archer, Broker.*



512.633.4650

SAM@ARCHERAUSTIN.COM

JUICEHOMES.COM

Shipe Pool Update... ...cont'd from page 3

Compared to earlier proposed designs, the Medley increases the main pool's water surface to 3648 square feet, only 350 square feet smaller than the present pool. It does this by adding a lap lane to previous designs, making the pool dimensions 75 feet long and 48 feet wide. This is still shorter than the current Shipe Pool length of 100 feet, but the design team made a case for a shorter pool. First, it wants to place the activity pool (kiddie pool) within the fenced area, in order to make it easier for families to supervise children of different ages. According to their survey, 60% of stakeholders favored a side-by-side pool arrangement. Second, they say that it will make it easier to staff lifeguards by having the two pools together. Third is the issue of accessible restrooms. State health and safety codes require restrooms be placed inside the fenced area. Fourth, 75 feet is the standard length in other PARD pools and also the standard for swim competitions, opening the possibility of summer swim leagues for neighborhood children.

The Medley also doubles the deep area compared to the present pool by shortening the transition area. Although City of Austin standards recommend 7 feet maximum pool depths, the Medley's maximum depth is 9 feet, one foot shorter than the deepest area of the present pool.

Shipe Park presents a challenge as a pool site. It is constrained by a large flood zone in the park space, the historic log cabin, the art mural, and the root zones of surrounding designated Heritage trees. This leaves little space for expanding the pool area. At the August HPNA general meeting, Adam Wilson led a lively discussion on the proposed Medley design. Fewer concerns were expressed about the shorter pool length than about the restroom placement along Avenue G. Stakeholders, by a small majority, preferred restrooms to be located along 44th Street, but the Historic Landmark Commission recommended against this placement because it impeded views of the log cabin. Concerns about restroom placement along Avenue G included obstructed views of the Ney from the pool area, blocked air flow, and excessive restroom space. In July, the design team explained that show-



Monthly Calendar September

- 2 — Recycling Pickup
- 12 — HPNA General Meeting & Ice Cream Social
- 15 — DRC Meeting
- 16 — Recycling Pickup
- 18 — Portraiture in the Park: Who Are You Anyway?! at the Ney
- 19 — HPNA Steering Committee Meeting
- 30 — Recycling Pickup

ers, toilets, urinals, and sinks are mandated by Texas code and must also meet ADA accessibility requirements. The restroom space will also be used for first aid and storage, according to the design team. While admitting unfamiliarity with the waiver process, they agreed to investigate the possibility of waiving some requirements to enable fewer restrooms on the site. They also promised to design restrooms compatible with the historic character of the neighborhood.

The Shipe Pool is still in the design phase. HPNA is on record as opposing any changes to the surface area of the existing Shipe Pool (see July meeting minutes in the August *Pecan Press*). As we deliberate the pool's future, one thing is certain: the current Shipe Pool will be replaced. Now it is time to give serious consideration to the Medley design and what further changes we can reasonably expect, given logistical and legal constraints.

To view the latest Shipe Pool design, PowerPoint presentations from previous meetings, and survey results, Google "Shipe Pool Improvements" or go to <http://austintexas.gov/shipepoolimprovements>.

— Susan Marshall



Proprietors:
Patricia Mares
Luke Zimmermann

Open 11 am till midnight
Seven days a week

29th & Guadalupe
477-1651

Catering
Dine In
Take Out
Delivery

RUBY'S B.B.Q

PAW PAUSE

Full Service Pet Staycations

Dolly Ensey
Certified Treat Dispenser

Tail Wag Ratings Available

512.553.6729 pawpausepets@gmail.com

News from the Ney

July and August saw the Ney successfully trying new things, including the Meet Her Hands series produced with #bossbabesATX and the wonderful Art Swap produced with Big Medium, and each event was a success. In fact, both Meet Her Hands and the Art Swap will almost certainly be repeated. Keep an eye on this space or the Museum's Facebook page for more information in the future.

The Ney and the neighborhood also saw some extraordinary weather. If you'd care to see some unusual footage of the August 17 flood, check out the museum's Facebook page. Also, who knew there would be rain lilies in August?

But with September here (where does it all go?), on Sunday, September 18 from noon to 4 pm, the Museum will be presenting one of its most treasured traditions, Portraiture in the Park, now taglined with "Who Are You Anyway?!" Elisabet was a prolific and extremely conscientious portraitist — she aimed to convey the character and often, the story, of her subjects in her work more than simply their appearance. So the idea behind Portraiture in the Park: Who Are You Anyway?! is to ask the big question: what does "portraiture" mean? What information do you or can

you convey in portraits? Taking that information, how many *new* ways can you think of to make portraits? The event asks participants to really think outside the box! This year, there will be a unique emphasis on old and new methods, ranging from some very interesting technology-based explorations like giant fractal heads and 3D printing all the way to good old-fashioned whittling, with John Vasquez, the Official Whittler of the State of Texas! Find out more through music, demos, exceptional art activities, caricatures, and more!

As usual, there will also be food trucks, ices, and more. Bring a picnic! This is a part of the 2016 Austin Museum Day celebrations, organized by the Austin Museum Partnership. You can find out more by reading the insert in the paper that week or by visiting www.austinmuseums.org/museumday/.

On Sunday, October 30, the Third First Annual POLKAPOCALYPSE! will feature two Grammy Award-winning bands — Brave Combo from Denton and Los Texmaniacs from San Antonio! So mark your calendars and have a great September and a terrific fall.



Faster Internet...

UNBELIEVABLE PRICE



GRANDE
COMMUNICATIONS®
Here For You

Power 50 Internet

- Up to **50 Mbps download**
- Up to **5 Mbps upload**
- Cable modem rental **included**
- Antivirus **included**
- Use all of your devices online at once

Digital Basic TV

- HD **included**
- DVR service and receiver **included**
- Local broadcast channels
- Pay-Per-View Access

ALL FOR ONLY

59⁹⁹
per month
for 12 months

NO CONTRACT REQUIRED + 30-DAY RISK-FREE TRIAL

512-220-0054 • mygrande.com/power



Like us on
Facebook



Follow us on
Twitter



Offer expires 12-31-14. Services subject to availability, please contact Grande for details. Offers only apply to first-time residential customers. \$59.99 Promotional Offer price is for 12 months and includes Power 50 Mbps Internet service with one cable modem rental and Digital Basic TV service with one HD/DVR receiver rental and service. Prices increase by \$5 for months 13-24 and an additional \$5 for months 25-36. Prices revert to then current applicable retail rate in month 37. If you change or disconnect any or all of the services at any time during the 36-month promotional period, the bundle pricing will no longer apply and Grande's then standard monthly rates will apply to remaining service(s). Monthly offer rates subject to applicable surcharges, equipment taxes, franchise fees and other government imposed charges. Installation, taxes, fees, additional receivers, equipment, additional services or features not included. Bundle also available with a CableCARD however interactive features are not available. Actual Internet speeds may vary and are not guaranteed. A credit check and/or deposit may be required. Not valid with any other offer and may not be transferred or redeemed for cash. Other restrictions may apply. ©2014 Grande Communications Networks, LLC. All rights reserved.

Around & About the Avenues

Filming in Hyde Park. Once again, Hyde Park was selected as a perfect filming location. In this case, the plot was based on the book *The Son*, by Philipp Meyer, a University of Texas graduate. The film will be broadcast as a series on AMC. The director selected 4200 Avenue F as the right house to fit this tale of a 1915 oil tycoon.



Hyde Park Once Again the Site of a Serious Crime. On July 26, at Clarkson and Red River, a bicyclist was robbed at gunpoint. KEYE-TV interviewed Hyde Park Crime and Safety co-Chair Carol Welder, who stated, "As close as we are to major arteries in the city I really do feel we are safe. The Hyde Park Neighborhood Association is very proactive when it comes to neighborhood issues, crime and safety." Carol went on to attend a meeting with Austin Police to raise concerns about the robbery.



From the Co-Presidents... ...cont'd from page 2

the Fire Station Festival in October and the Hyde Park Homes Tour in November. Each of these events brings many people into our neighborhood and displays the best in Hyde Park. We hope you will attend. But even more importantly, we hope you will be able to volunteer a couple of hours to make these events a success. We have found that participating in putting together neighborhood events is not only rewarding but fun as well.

We regret that our customary August Ice Cream Social was first postponed and then cancelled due to the rain. However, join us at the September meeting. We'll begin with ice cream before we move on to business. And we want to thank Sarah Cook, Adrian Skinner, and Kathy Lawrence for their efforts to organize the event.

— Kevin Heyburn & Reid Long
HPNA Co-Presidents

Soft Touch - High Tech Dentistry

Francys Day DDS



WWW.AUSTINMILESBYDAY.COM • 512-452-4495

1301 W 38th St, Suite 708 • Austin, TX 78705
(Located in Medical Park Tower, next to Seton Shoal Creek Hospital)

Accepting New Patients

NEW PATIENT SPECIAL
Includes New Patient Exam, Full
Series of X-Rays, and
Oral Cancer Screening.

*New patients only. Must mention this
ad to receive this special.

**JUST
\$98**

Join Us at Our New Location



MIDTOWN
CHURCH

a church of central austinites
for central austinites

3908 AVENUE B
MEETS IN BAKER SCHOOL IN HYDE PARK
SERVICE TIME: SUNDAYS @ 10:45AM
WWW.MIDTOWNAUSTIN.ORG

LOVE | SERVE | AUSTIN

Jim-Dandy, Inc.

 Home Improvement
 Remodeling
 Repair
 And Handyman Services
 "No job too small"
Jim Cardwell
 (512) 422-9606
 jim-dandyinc.com

Austin Tree Experts
 Locally owned by
Keith Brown
 Board Certified Master Arborist
 Pruning | Removal
 Treatment Programs
 Consultation
 996-9100
 www.AustinTreeExperts.com

HYDE PARK

Conans Pizza since 1976!
 Austin's Original Deep Pan
 603 W 29th @ Guadalupe
 (512) 478-5712
\$3 OFF ANY LARGE
 (must present this coupon)
 Exclusive offer for our
HYDE PARK NEIGHBORS

A vibrant and engaged high school community

GRIFFIN SCHOOL
 Cultivating individual potential
 and intellectual curiosity
 www.griffinschool.org

**Kid's Corner:
 What's for Lunch?**

Welcome to the Pecan Press Kid's Corner where you can find out about kid happenings in Hyde Park. Feel free to submit anything kid related, including event info, kid's drawings, stories, comics, songs, poems, what have you! ppkidscorner@yahoo.com

Okay, I know it's only September, but are your littles and bigs already bored with what you so thoughtfully pack in their lunch boxes? Or, well, are you already scanning the fridge and pantry looking for new ideas? Here's a fun quiz you can give your lunch takers. Hopefully it will help you, the lunch packer, with some ideas. You just might be surprised by some of their answers. Of course, you can always have them pack their own lunch!

Lunch Box Quiz

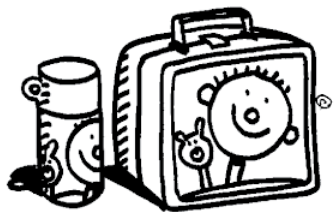

- Sandwiches cut into
 - Rectangles
 - Triangles
 - Squares
 - Fun cookie cutter shapes!!
 - Ugh - please no sandwiches (yikes!)
 - Nut-free classroom or school? How about
 - Sun butter sandwiches
 - Cream cheese and jelly (or even cucumber) sandwiches
 - Grilled cheese (even if it's cold?)
 - Turkey, cheddar, and green apple sandwich
 - Veggie delight! - Hummus, shredded carrots, and other veggies
 - What would you like for lunch other than a sandwich?
 - Hmm... Chicken tenders (even if they're cold?)
 - Yeah, chicken tenders
 - Pasta
 - Marshmallow shish kabobs!! Okay, meat, cheese, veggie ones work, too.
 - Breakfast for lunch - hard-boiled eggs or waffle sandwiches
 - To drink?
 - H2O
 - Chocolate milk...please!
 - OK, milk
 - Smoothie
 - Juice box
 - Yummy treats?
 - Apple slices with nut butter and raisins
 - Couple of cookies
 - Fruit chew gummies
 - Fruit leather work, too
 - Muffin, even if it has the green stuff (um, zucchini) in it
- Oh, skip it and let's head to Quack's after school!

Word Find: Novelists

N O V E L I S T S I N A L I S T
 M A O G U H R O T C I V E R D I
 N I G H T T I M E S T Y P O O H
 G E T A K H A N A N E M O M M E
 I T S I T S O K S L E W A A L L
 V O I S E H D M L L T N R U S L
 O N C L E I A E A A L C R S U E
 K M U E N H H C T S E E A E N R
 O J E E O S N E H L M R W I V V
 B A S L Y T R N P R G A A G O O
 A E R R V A R R A R I W N N H L
 N E A T G I O E E M T S N N I T
 O M A R C U L T B K R E T I N A
 C L A S S U N L R M G E M I N I
 S M U T T U N A E U U S H H E R
 A L O Z G A M E T O L K I E N E

The numbers in parentheses refer to the number of letters in the answers.

1. *The Handmaid's Tale* (8,6) _____
2. *The Tin Drum* (6,5) _____
3. and #4 *Around the World in 80 Days* (5) _____
4. see 3 (6) _____
5. *Catch 22* (6) _____
6. *Moby Dick* (8) _____
7. *Born Free* (4,7) _____
8. *The Name of the Rose* (7,3) _____
9. *The Hunchback of Notre Dame* (6,4) _____
10. It's a mystery how she wrote so much! (6,8) _____
11. *The Time Machine* (1,15) _____
12. Nobelist; *Steppenwolf* (7,5) _____
13. *Frankenstein* (4,7) _____
14. Dreyfus defender (4) _____
15. Gave us Tom and Huck (4,5) _____
16. *In Search of Lost Time* (6,6) _____
17. Gave us orcs and Frodo (7) _____
18. *Candide* (8) _____
19. *Slaughterhouse Five* (8) _____
20. Nobelist; *The Magic Mountain* (6,4) _____
21. *Lolita* (7) _____

Answers on page 13



Local CONNECTION!

BEST OF AUSTIN 2015
VOTED Best NEIGHBORHOOD GROCERY STORE

3101 GUADALUPE 4001 S. LAMAR
512-478-2667 512-814-2888

WHEATSVILLE FOOD CO-OP

OPEN DAILY: 7:30 AM - 11 PM
WWW.WHEATSVILLE.COM

URBAN ROOTS FARM
6 MILES FROM WHEATSVILLE

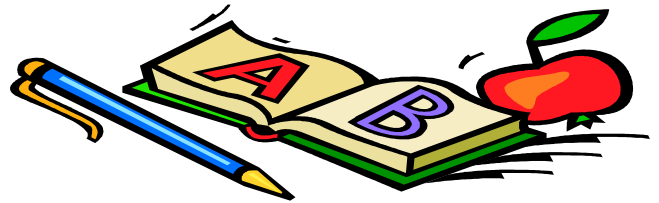

At this time of year we think of folks returning from summer vacations and of children returning to school. Let us also think, at this time, of returning to God – of making real and intentional efforts to bringing our hearts and minds and bodies and souls back into right relationship with God.



Hyde Park Christian Church

Every Sunday at 10:30 a.m.

610 E. 45th Street

Visit us!

hydeparkcc.org



4001 DUVAL HAIR SALON
An Aveda Concept Salon

FULL SERVICE SALON & ART GALLERY

AVEDA
THE ART AND SCIENCE OF PURE FLOWER AND PLANT ESSENCES

4001 DUVAL STREET 512.451.4034



NOT SUCKING SINCE

1993

Come See What All The Hype Is About!

With 2 Convenient Locations!

Yost I
5415 N. Lamar
512-374-9678



Yost II
6517 N. Lamar
512-452-9678

WWW.YOSTAUTO.COM

gusto
italian kitchen + wine bar

4800 BURNET ROAD
512.458.1100
gustoitaliankitchen.com

Bring this ad in for a complimentary pizza, pasta, panini, or entree with the purchase of another of equal or greater value.

it's on us

Limit one per table. Not good with any other offer.
Expires 9.30.16.



LUNCH
mon-fri 11-4

HAPPY HOUR
daily 4-7

DINNER
sun-thur 4-10
fri-sat 4-10:30

BRUNCH
sun 10-3

HPNA General Meeting Minutes: August 1, 2016

The meeting was called to order at 7:06 pm by co-President Reid Long at the Griffin School, 5001 Evans Avenue.

The first agenda item was a vote on the letter of support to the Austin City Council for the Elisabet Ney Museum, which is seeking funding to add a full-time staff member. Co-President Kevin Heyburn read the letter and then introduced Oliver Franklin, the director of the Ney. He explained the necessity and job description of the Curator of Collections position for which he seeks funding. They are short-staffed by a recent departure and have increased their activities in recent years, particularly on the Ney grounds. The letter was approved by a vote of 19 in favor, 1 opposed, and 0 abstentions. It reads as follows:

Dear Mayor Pro Tem Tovo:

The Elisabet Ney Museum (“the Ney”) houses a priceless collection of art and artifacts in a beautiful and historic castle in the heart of our neighborhood. We are proud of the numerous visitors from all over the world who travel to Hyde Park to learn about Elisabet Ney and to see the beautiful art she created. Furthermore, we are grateful for the numerous events that the Ney’s Director, Oliver Franklin, and his small staff coordinate, which attract Austinites of all ages to the Ney’s grounds.

Because our neighbors enthusiastically support the Ney Museum and the benefits it provides to the City, we are writing to you, on behalf of the Hyde Park Neighborhood Association (HPNA), to request that you and your fellow council members fund a full-time Curator of Collections position at the Ney, a position that Austin’s Parks and Recreation Department has designated as an “Unmet Need” in its budget. The Ney has had a staff member fulfilling that need on a part-time basis, but due to recent changes this is no longer the case. We urge the City Council to fund a full-time Curator of Collections position to ensure that the Ney Museum’s collections continue to have the best of care and allow the current staff to continue the high quality programming that they have developed for Austinites and guests from around the globe.

Sincerely,

Kevin Heyburn
Co-President, HPNA

Reid Long
Co-President, HPNA

Reid Long next requested a show of hands from HPNA members attending their first meeting. Several new members introduced themselves.

The second agenda item was a resolution on a light rail referendum. Scott Morris of the non-profit Central Austin Community Development Corporation (CACDC) spoke in favor of the resolution. He provided a brief

history of the issue, summarized Mayor Adler’s \$700-million bond proposal that advocates a corridors approach focused on roads, and reported polling data indicating that a majority of Austinites today support a new tax to fund light rail. He explained the rationale for the Guadalupe-North Lamar minimum operable segment of 5.3 miles, estimating an average weekday ridership of 34,000, which is considerably higher than the current weekday bus ridership of 18,000 along the corridor. The roughly \$400-million light-rail bond proposal follows the Houston model of using 100% local funds for quicker construction. Many questions followed, including the impact on car traffic of a dedicated rail lane, the impact of rail on existing bus service, rider convenience, rail efficiency and reliability, and the lack of parking facilities at rail stations. Morris explained that many existing bus routes could be eliminated and converted to feeder lines between stations, that rail stations will be about a half-mile apart, and that the suggested rail route is along a heavily populated corridor of potential riders. Members voted to call the question by a vote of 24 in favor, 0 opposed, and 2 abstentions. The vote on the resolution was 20 in favor, 1 opposed, and 6 abstentions. The resolution reads as follows:

WHEREAS the population of Austin has grown dramatically in recent years, and the increased size of the population of Austin necessitates that additional options for public transportation in general become available, AND

WHEREAS, specifically, the State of Texas has announced the construction of a new office complex around the Winters Building on 51st Street, which will lead to an increased need for transportation to and from that area, which will significantly increase automobile traffic through our neighborhood, AND

WHEREAS the Central Austin Community Development Corporation (CACDC) has proposed the construction of a light rail system on the Lamar-Guadalupe corridor, AND

WHEREAS the Hyde Park Neighborhood Plan, adopted by the City of Austin, supports a light rail system on that corridor and requests that all stakeholders be involved in the planning process,

THEREFORE, be it resolved that the Hyde Park Neighborhood Association requests that Austin City Council include on the November, 2016 election ballot a bond proposal for the construction of a light rail system on the Lamar-Guadalupe corridor as proposed by CACDC.

The final agenda item was an update on the redesign for Shipe pool. Adam Wilson presented the latest design, called “The Medley,” and summarized the history of neighborhood input into the design process. As a result of neighbors’ input, the pool surface area has been increased by adding width (one lap lane), and the deep

Continued on page 17

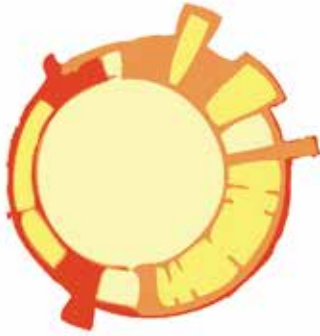

Sunny Day
REAL ESTATE
Austin, TX



Broker:

J. Reed Henderson

cell: (512) 743-6298

reed@sunnydayaustin.com

Agent:

Regina Henderson

cell: (512) 924-4456

regina@sunnydayaustin.com

We are here to help with all of your real estate needs!

**WE WORK
FOR PEOPLE,
NOT DEALS.**

COMMITTED TO HYDE PARK SINCE 2000

HOMESVILLE.COM

HOMESVILLE

REAL ESTATE



JEN BERBAS

512.300.2995

jen@homesville.com

Answers

NOVELISTSINALIST
MAGGURHOTCIVERDI
NIGHTTIMESTYPOOH
GETAKHANANEMOMME
ITSITSOKSLEWAALI
VOISEHDMLLTNRUSL
ONCLEYAEALCRSUE
KMUEENHHCSTSEEAENR
OJEEQSNEHLMRWIVY
BASLYTBNPRGAAGOO
AERRVARRARIWNNHI
NEATGIOEEMTSNNIT
OMARCELLTBKRETINA
CLAS SUNLRMGEMINI
SMUTTUNAEUUSHHER
ALOZGAMEFOLKIENE

1)MARGARET ATWOOD; 2)GUNTER GRASS; 3)JULES; 4)VERNE;
5)HELLER; 6)MELVILLE; 7)ISAK DINESEN; 8)UMBERTO ECO;
9)VICTOR HUGO; 10)AGATHA CHRISTIE; 11)H G WELLS;
12)HERMANN HESSE; 13)MARY SHELLEY; 14)ZOLA; 15)MARK
TWIN; 16)MARCEL PROUST; 17)TOLKIEN ; 18)VOLTAIRE;
19)VONNEGUT; 20)THOMAS MANN; 21)NABOKOV

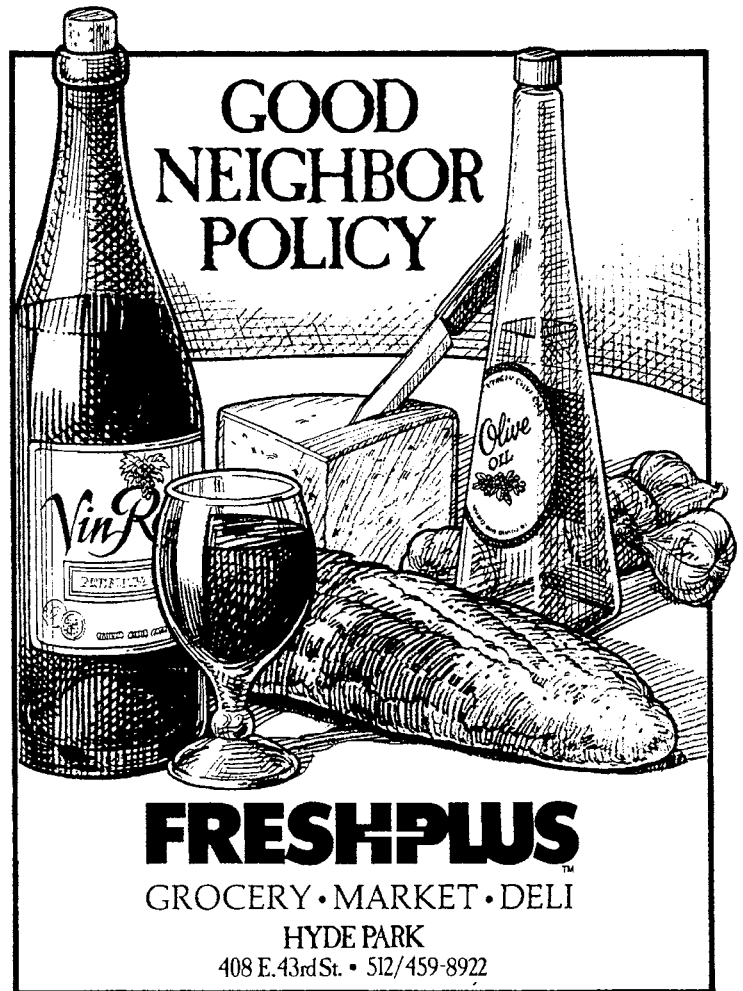

GOOD NEIGHBOR POLICY

FRESHPLUS
GROCERY • MARKET • DELI
HYDE PARK
408 E. 43rd St. • 512/459-8922

Calling Volunteers... ...cont'd from page 1

volunteer for a specific event or task. The online form asks three questions: your name, your email, and whether you're interested in particular events or just volunteering in general. Once you sign up, you'll be contacted to review specific event-related opportunities as they arise.

There are plenty of volunteer options, from quick one-off assignments to longer term planning and organizing or day-of-event staffing and support; the neighborhood will be grateful for your help, whatever works for you. We are also able to verify volunteer activities for students who have community service obligations - so please sign up, high schoolers!

Use one of these ways to get engaged and show that you're interested in helping out:

- Use the link to the volunteer form posted on the Hyde Park Neighborhood Association website at www.austinhypark.org;
- Use the link on the Yahoo group HydeParkAustin listserv or www.NextDoor.com, where it will be posted monthly;
- Email Sarah Cook at cooksicle@gmail.com to receive the form through email.

The Hyde Park Neighborhood Association looks forward to working with you soon!

— Sarah Cook,
HPNA Social Chair



i BIRDS BARBERSHOP
austin

vivian, trivia queen
ladybird, \$45

photo by alison narro

for locations and stylist schedules, visit birdsbarbershop.com



4503 Red River \$495,000 · Coming soon
3 beds · 1 bath · 1213 sq ft · .25 acre lot



3905 Duval Street · For lease \$3250/month
3 beds + office · 2 baths · 1690 sq ft



1120 Fairmount Ave, Unit B · \$649,950
3 beds · 2.5 baths · 2026 sq ft

Find the Austin home you love at SEEDpropertygroup.com



TAMMY YOUNG
Owner, Broker
GRI, Platinum Top 50

512-695-6940 c
tammy@seedpropertygroup.com



Rooted in results.

Your Hyde Park Neighbor. I live here. I work here.



PRESENTED BY
LIN TEAM, OLD AUSTIN REALTOR®
LANDMARK PROPERTIES

VintageAustinHomes.com
OldAustinRealtor.com

Here is a rare opportunity to own a Historic Landmark meticulously restored by top Austin professionals. The details of the Victorian Queen Anne Cottage are so well preserved that to walk up the path and enter the beautiful Wilkins-Heath house takes you back to the world of 1888. Set in a naturalized secluded oasis in the Fairview Park area of Travis Heights, it must be seen to be fully appreciated. 512-917-1930 or email LTeam@austin.rr.com for an appointment.

The Arts in Hyde Park

Kate Musemeche and Hurt: The Inspiring, Untold Story of Trauma Care

When longtime Hyde Park resident Catherine “Kate” Musemeche was growing up in Orange, Texas, she discovered two things about herself: she was good at science and she admired the people in her community who were helping others. So this daughter of a nurse found a job working in the emergency room of a hospital and eventually fell in love with medicine. She made up her mind to become a doctor.

Kate took pre-med courses in San Antonio and Austin and earned her medical degree in Houston. She became a specialist in pediatric medicine,



Kate Musemeche

performing surgeries on children who had suffered injuries in motor vehicle accidents, from hit and runs, and – on occasion – as the result of gunshot wounds. Her experiences as a pediatric surgeon led her to write her first book, *Small: Life and Death on the Front Lines of Pediatric Surgery*.

Kate Musemeche has now published her second book, *Hurt: The Inspiring, Untold Story of Trauma Care*. A trauma injury to the body, Kate explained during an interview, is any injury that threatens life or limb. Trauma is a disease of epidemic proportions that preys on the young, killing more Americans up to the age of thirty-seven than all other afflictions combined. Every year an estimated 2.8 million people are hospitalized for injuries, and more than 180,000 people die of those injuries.

In her new book, Kate explores the history of trauma care from the American Civil War to the present. She describes General Ulysses S. Grant’s visit to a field hospital on the eve of the Battle of Shiloh, where he saw injured soldiers, many with their arms or legs amputated. General Grant said that the sight of his wounded men was more unendurable than encountering the enemy’s fire. It was the suffering in the Civil War that led to great advances in the way America took care of its traumatically injured. Later wars and other tragic events led to further medical and logistical innovations that now regularly save arms, legs, and lives. Kate describes the events, the doctors, and the nurses that developed the trauma services and techniques that are now part of our national life when a natural or man-made disaster strikes.

In a review of her first book *Small*, *Maclean’s* magazine said that Kate Musemeche “writes with a kind

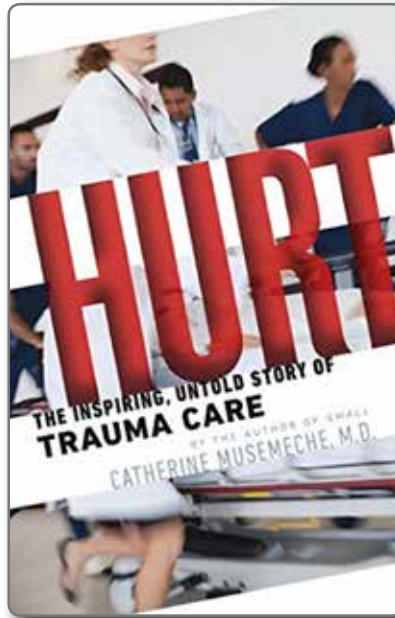

of drama that feels as visceral as viewing a documentary.” *Publisher’s Weekly* says that in her new book, *Hurt*, Kate’s “...fast-paced medical history mixes the gritty reality of treating life-threatening injuries – including her own heart-pounding experiences as surgeon – with an unfettered optimism about what trauma care can now promise: an assurance that

most people will survive even a devastating injury.”

More information about Kate Musemeche’s books can be found on her web site, www.hurtthebook.com. Kate will be hosting book signings at the following places: BookPeople, Austin (9/9/16); Barnes & Noble La Cantera, San Antonio (9/11/16); River Oaks Bookstore, Houston (9/17/16); BookWoman, Austin (10/13/16); and Barnes & Noble at The Homestead, Austin (10/14/16).

– Kevin Heyburn

Flooding...

...cont'd from page 1

This has placed a high financial burden on homeowners who are required to pay from four to six thousand dollars a year in mandatory insurance under FEMA rules that also impose restrictions on the value of future home improvements. Some speakers reported difficulty selling their homes now located within the flood plain. Their experiences expose another side of the plan to make Austin affordable by adding density to central Austin neighborhoods, as middle-income residents in the expanded flood plain face higher living expenses, expenses they could not have anticipated when they purchased their homes.

The FMTF adopted several recommendations focused on the negative effects of development on neighborhood flooding. It requested that the City of Austin neither grant variances for development or redevelopment that might lead to future flooding nor annex property that might already be a flood concern. It urged that the City enforce the requirement that all proposed land development projects, whether new or redevelopment, demonstrate no adverse downstream impacts. Task Force members clarified that "development" refers to any changes that increase impervious cover. It also recommended that all redevelopment meet the drainage criteria for an undeveloped condition, reducing runoff leaving the site to "greenfield" conditions.

The forum identified some actions that residents in affected neighborhoods can take. First, the more data the better, according to the Watershed Protection Department. They want to collect videos and photos as evidence of flooding problems. Go to www.atxfloods.com and click **Contact** on the menu bar to upload files. Second, sign up for flood alerts at this website if you live in a flood-prone area. Third, call 311 to report all flooding issues, because these are logged and become part of the public record that is useful to City staff. More broadly, because our central Austin neighbors face similar flooding issues, we might consider partnering with them to counter the city's narrative on infill and development that has largely ignored the impact on older neighborhoods downstream.

As County Commissioner Brigid Shea noted at the forum, global changes paired with Austin's rapid growth will only make flooding events more common and more extreme. This issue affects all residents, as homes currently outside of the flood plain might experience flooding in the future unless action is taken. While the financial implications of flooding are significant, the forum began and ended with the sober reminder that flooding is also a public safety issue that puts lives at risk.

— Susan Marshall



Paige's Kitchen Addition,
78704

We design and build around you
so you feel right, at home.

CGSDB.COM | 512.444.1580



If your car could talk...

It would choose the Muffin Shop

512-453-5287
6615 Shirley Ave.
www.muffinmuffler.com

PLEASE ENTER YOUR PASSWORD

Please enter your password.
Password is incorrect.
Password does not match our records.
You have exceeded the number of allowed attempts.
Forget your password?
Do you want to reset your password by email?
Do you want to reset your password by answering security questions?
--Simple things I will surely remember:
Favorite teacher (6th grade? Mr. Thomas? Henry Thomas? High school?
Mr. Whitfield? Raymond Whitfield? College? Dr. Willis? Richard Willis? Dr. Richard Willis?
There are only so many attempts allowed, usually 3, then what ?!?!)

Write your new password.
Password is weak
Password needs 8 letters
At least 1 number
May contain (this is how I feel BTW) @\$#%^&*#)
Password is moderate
Password needs 8 letters
At least 1 number
May contain (this is how I feel BTW) @\$#%^&*#)

Keep your password in a secure place
TRY-TO-REMEMBER-YOUR-PASSWORD
From one @\$#%^&*# time to the next

Password must be changed every 6 months
Do not use a password you have used the last 20 times
Re-invent yourself
Restart your brain
Get a new brain...
Need a new brain?
Join "Need a new brain.com"
We will never share your information with anyone.
Enter your username
Enter your password.
Re-enter your password.
@\$#%^&*#
@\$#%^&*#
@\$#%^&*#

— *Herzele*
05/23/16



GREAT AFTER SCHOOL PROGRAM

SUMMER SPECIAL

1-MONTH \$69 INCLUDES UNIFORM

MAX TAEKWONDO
Summer Camp (No Experience Needed)
Ages 3-99 (Specific Classes For Each Age Group)
Yoga Available For Parents During Classes
Develop Self Discipline, Respect and Self Esteem
Increase Flexibility and Coordination
Instill Self-Respect and Respect For Others
Develop Better Focus and Concentration
AISD OCPE and Home-School Classes Available

MAX MARTIAL ARTS ACADEMY
6929 Airport Blvd. Suite 146
(Corner of Airport & Lamar)
Austin, Texas 78752
512-371-8989 • maxtkdyoga.com
VETERAN OWNED

August Meeting Minutes... ...cont'd from page 11

area is twice that of the present pool. With these design changes, the surface area difference between the present pool and the suggested design is about 350 square feet. Kevin Heywood reminded members that an HPNA resolution supported maintaining the 100 foot length of the present pool. The Medley design presented in July moves the activity pool ("kiddie pool") to the enclosed pool area, allowing no space for a longer pool. As the discussion proceeded, the biggest point of contention was the placement of restrooms along Avenue G. Various suggestions were made about how to change the placement of the restrooms, including pressing the city for a variance to reduce the number of required fixtures. Members with suggestions were encouraged to contact Adam Wilson (adam@griffinschool.org) or Kevin Heyburn (kmheyburn@gmail.com).

Announcements included the Ice Cream Social on August 15 in Shipe Park and pool closings in August. The meeting was adjourned at 8:40 pm.

— *Submitted by Susan Marshall,*
Co-Secretary, HPNA



"Smart Decisions About Serious Money"

Serving Hyde Park for 24 Years

Did you know that we are available to speak to your professional group, office, or organization?



Some of our most popular topics include:

"College, Credit Cards, & Cutting the Cord—The thinking parents guide to managing your kids through college"

"Teaching Your Kids / Grandkids About Money"

"Leaving a Lasting Legacy"

Contact us at 512-458-2517 if you are interested in scheduling one of our talented speakers for an upcoming event!

www.lsggroup.com

A Registered Investment Advisor Providing Fiduciary Level Planning, Advice & Asset Management Services

Hyde Park Contact Team Quarterly Meeting Minutes: July 25, 2016

Co-Chair Adrian Skinner called the meeting to order at 7:17 pm at 3811 Avenue H.

The first agenda item was a presentation by Scott Morris of the Central Austin Community Development Corporation (CACDC). He is seeking support for a November referendum on light rail. This would be the Guadalupe-Lamar minimum operable segment, running 5.3 miles between the existing Metro Rail Crestview Station and Republic Square. His contention is that Mayor Adler's \$700 million bond referendum for transportation improvements (roads, sidewalks) is a good time to ask voters to think big about mass transit. The proposed light rail referendum requests \$397 million. The proposed line will consist of 11 light rail stops with feeder buses carrying passengers between stops. Discussion of the resolution included questions about route usage and passenger convenience, dedicated lanes for car traffic, and traffic congestion issues.

The following resolution on light rail passed by a vote of 9 in favor, 0 opposed, and 3 abstentions:

WHEREAS, the Hyde Park Neighborhood is a dense residential neighborhood that has a history of being served with light rail and was the first electric streetcar suburb in Texas; and

WHEREAS, the Hyde Park Neighborhood Plan (City of Austin Ordinance 000413-63) carries specific contingencies for a light rail alignment on Guadalupe Street; and

WHEREAS, Goal 3 of the Hyde Park Neighborhood Plan calls for light rail planning support to enhance existing pedestrian, businesses, and residential uses; and

WHEREAS, Goal 5 of the Hyde Park Neighborhood Plan calls for full stakeholder participation in a corridor plan that includes light rail; and

WHEREAS, the Hyde Park Neighborhood Plan Contact Team is charged by city ordinance to implement the Hyde Park Neighborhood Plan; and

WHEREAS, residents of several other nearby neighborhoods have called for light rail along the Guadalupe-North Lamar corridor, expressed as input in neighborhood plans such as the Central Austin Combined Neighborhood Plan (City of Austin Ordinance 040826-56), Crestview-Wooten Combined Neighborhood Plan (City of Austin Ordinance 040513-30), Brentwood-Highland Combined Neighborhood Plan (City of Austin Ordinance 040513-30), and the North Loop Neighborhood Plan (City of Austin Ordinance 020523-30); and

Continued on following page

Hyde Park Neighbors –

Biggs Plumbing, a commercial contractor for over 40 years, is now providing residential service.

Consider us for your:

- Kitchen and bath remodeling
- New tankless water heaters
- Service calls

We live in the neighborhood and understand the challenges of older plumbing. Let us help you with your next project.

512-837-5955

service@biggsplumbing.com

<http://www.biggsplumbing.com>



TX Masters License M36811

WHEREAS, the Hyde Park Neighborhood Plan Contact Team passed a resolution on June 5, 2012 calling for light rail corridor planning on Guadalupe Street; and

WHEREAS, the Central Austin Neighborhoods Planning Advisory Committee (CANPAC), a city-formed planning body that is charged with planning recommendations for a seven-neighborhood planning area abutting and to the south of the Hyde Park Neighborhood Planning Area, passed a resolution on October 29, 2013 demanding that Guadalupe Street receive priority designation for light rail; and

WHEREAS, Mayor Steve Adler declared 2016 as the Year of Mobility and has recommended that a transportation bond package be put to the voters in November 2016; and

WHEREAS, the Central Austin Community Development Corporation has developed a proposal for a 5.3-mile minimum operable segment of light rail to be built between Crestview Station and Republic Square along Guadalupe Street in an alignment that is consistent with the Hyde Park Neighborhood Plan;

THEREFORE, BE IT RESOLVED, the Hyde Park Neighborhood Plan Contact Team believes that any effective effort to address the city's mobility problems must include transit; and

BE IT FURTHER RESOLVED, the Hyde Park Neighborhood Plan Contact Team reiterates that light rail belongs in the city's densest corridor along North Lamar Boulevard and Guadalupe Street; and

BE IT FURTHER RESOLVED, the Hyde Park Neighborhood Plan Contact Team supports a November 2016 city ballot measure authorizing the issuance of \$397 million in bonds for the purpose of building a minimum operable segment of light rail on Guadalupe Street in an alignment that is consistent with the Hyde Park Neighborhood Plan.

The second agenda item concerned neighborhood speed limits. Adrian Skinner explained that some residents expressed concerns with 30-mile speed limits on many streets. In response to a question about whether speed limits constitute this body's area of responsibility, relevant text in the Hyde Park Neighborhood Plan was found. A heavily-edited amendment was proposed that focused on the HPNP as a rationale for a speed limit resolution. The vote for this resolution was 6 in favor and 6 opposed. Discussion of the resolution also included issues of stop signs and sidewalks; these items were tabled for a future meeting. The motion for an amended speed limit resolution that added references to the Hyde Park Neighborhood Plan passed by a vote of 13 in favor, 0 opposed. The resolution reads as follows:

WHEREAS Hyde Park is a residential neighborhood close to the University of Texas and is highly frequented by pedestrians and bicyclists; and

WHEREAS the streets of Hyde Park are without a fully connected sidewalk grid; and

WHEREAS pedestrians - including children - and bicycle traffic must mix with automobiles traveling on narrow, unstriped roads that have cars parked along both sides; and

WHEREAS an audit of City of Austin speed limit records reveals that a number of residential streets in Hyde Park permit speeds of 30 MPH, often resulting in commuters traveling in excess of 30 MPH; and

WHEREAS studies of pedestrians involved in accidents with automobiles* show that serious injury is more likely to occur at higher speeds; and

WHEREAS the Hyde Park Neighborhood Plan promotes a neighborhood-friendly system of transportation that improves safety for pedestrians and bicyclists;

IT IS RESOLVED, the Hyde Park Neighborhood Plan Contact Team calls on the City of Austin to reduce all residential streets (except Duval Street and 45th Street) currently marked for speeds of 30 MPH to 25 MPH.

*" ...the average risk of severe injury for a pedestrian struck by a vehicle reaches 10% at an impact speed of 16 mph, 25% at 23 mph, 50% at 31 mph, 75% at 39 mph, and 90% at 46 mph. The average risk of death for a pedestrian reaches 10% at an impact speed of 23 mph, 25% at 32 mph, 50% at 42 mph, 75% at 50 mph, and 90% at 58 mph." (Source: www.aaafoundation.org/sites/default/files/2011Pedestrian-RiskVsSpeed.pdf).

The third agenda item concerned the planned HHSC building expansion in the 700 block of West 51st Street. The plan, to be completed in three phases, includes one million square feet of office space and three parking garages for 5800 cars. Discussion included procedural issues such as city and stakeholder input as well as the potential neighborhood impact on traffic and drainage. The consensus was that a resolution at this time is not the best course of action; instead, a group of volunteers will informally discuss these plans with our representatives in the state legislature and other public officials and monitor the progress of the building plan.

The major announcement was the annual report of the Imagine Austin Plan, which includes the designation of the stretch of Guadalupe between 29th and 51st Streets as an "activity corridor." This was done without notification or input of the affected neighborhoods. Activity corridors allow exemptions to ADU parking requirements. More research on this issue is needed and contact with the city's Planning Commission will follow.

The meeting was adjourned at 8:52 p.m.

Submitted by Susan Marshall



HYDE PARK & NORTH UNIVERSITY HOMES GALLERY



102 WEST 32ND STREET
 1930s Colonial Revival with guest house and swimming pool. Main house has 3,064 SF with 4 BR, 4 BA, 2 LIV, 2 DIN. Beautifully updated kitchen & baths. 1-car garage.
 Listed at \$1,045,000



504 WEST 33RD STREET
 Hemphill Park Townhomes. Quiet end unit, approx. 2,750 SF, 3 BR, 3 BA, 2 LIV, updated kitchen, large private courtyard, 2-car garage. No HOA or monthly fees.
 Listed at \$650,000



838 EAST 37TH STREET
 Spacious 1940s stone house located just south of Hancock Golf Course. 2,271 SF, one-story with 3 BR, 3 BA, 1 LIV, 2 DIN, 2-car garage. Walk to UT and Lee Elementary.
 Listed at \$699,000



4605 EILERS AVENUE
 Classic Hyde Park bungalow with 2nd story master addition. Open floor plan, approx 2,010 SF with 3 BR, 2 BA, 2 LIV. Also available for lease in July, \$3,200/mo.
 Listed at \$675,000



201 WEST 32ND STREET
 Available now! Unique 1928 stucco home located in historic Aldridge Place. 3-4 BR, 2 BA, 2 LIV. Hardwoods, beamed ceilings, Weigl ironwork, stained glass windows.
 Listed at \$3,650/month



3303 LIBERTY STREET
 Beautiful modern Craftsman style home with high-end finish-out. Maple flooring throughout. Gourmet kitchen. 3 BR, 2.5 BA, 2 LIV, 2 car garage.
 Listed at \$989,000



821 HARRIS AVENUE
 1930s storybook cottage just steps from Lee Elementary. 3 BR, 2 BA, 2 LIV, formal dining. Upstairs master suite. Stone patio, pergola, private gardens. Detached workshop.
 Listed at \$650,000



3306 HARRIS PARK AVENUE
 Charming renovated 1930s duplex available mid August. Upstairs unit looks out onto treetops. 2 BR, 1 BA, 1 LIV, 1 DIN, screened-in porch. Quiet street six blocks from U.T.
 Listed at \$1,995/mo.

The Central Austin real estate market remains strong! Contact your neighborhood expert for a complimentary market analysis and customized marketing plan for your property.

Suzanne Pringle

Broker, REALTOR®

512.217.1047

suzanne.pringle@sothebysrealty.com



Kuper

Sotheby's
 INTERNATIONAL REALTY

